

Soldering - Solderen - Soudage - Löten - Soldadura - Lötning - Juottaminen - Saldatura - Solda

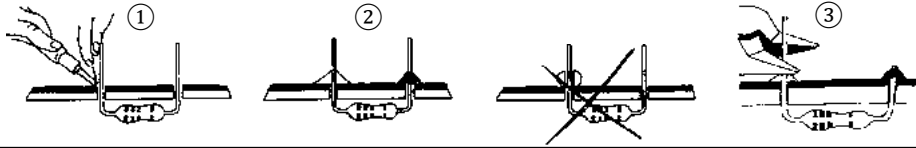

Component side - Componentzijde - Côte composants - Bauteileseite - Lado de los componentes

START

1

Resistor - Weerstand - Résistance - Widerstand - Resistencia - Motstand - Vastus - Resistenze

- ◇ R1: 4M7 (yellow, purple, green) - (geel, paars, groen) - (jaune, violet, vert) - (gelb, violett, grün) - (gul, Lila, Grön) - (keltainen, purppura, vihreä) - (amarillo, morado, verde) - (amarolo, violeta, verde) - (giallo, viola, verde)
- ◇ R2, R3 : 10K (brown, black, orange) - (bruin, zwart, oranje) - (brun, noir, orange) - (braun, schwarz, orange) - (brun, svart, orange) - (ruskea, musta, oranssi) - (marrón, negro, naranja) - (castanho, preto, laranja) - (marrone, nero, aranciato)
- ◇ R4 : 22ohm (red, red, black) - (rood, rood, zwart) - (rouge, rouge, noir) - (rot, rot, schwarz) - (röd, röd, svart) - (punainen, punainen, musta) - (rojo, rojo, negro) - (encarnado, encarnado, preto) - (rosso, rosso, nero)
- ◇ R5, R6: 1K (brown, black, red) - (bruin, zwart, rood) - (brun, noir, rouge) - (Braun, Schwarz, Rot) - (brun, svart, röd) - (ruskea, musta, punainen) - (marrón, negro, rojo) - (castanho, preto, encarnado) - (marrone, nero, rosso)
- ◇ R7: 2K2 (red, red, red) - (rood, rood, rood) - (rouge, rouge, rouge) - (Rot, Rot, Rot) - (röd, röd, röd) - (punainen, punainen, punainen) - (rojo, rojo, rojo) - (encarnado, encarnado, encarnado) - (rosso, rosso, rosso)

2

Ceramic capacitors

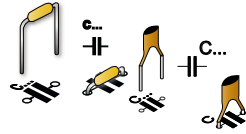

◇ C1...C6: 100nF (104)

3

Diode

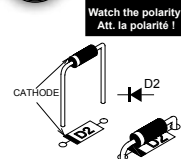

◇ D1: 1N4007

4

IC-Sockets

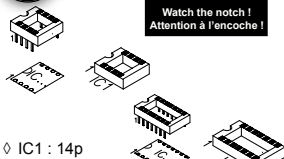

◇ IC1 : 14p
◇ IC2 : 8p

5

Array resistor

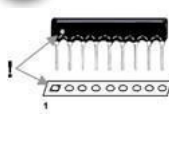

◇ RA1 : 10K

6

LED

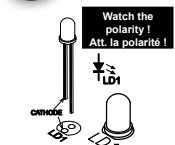

◇ LD1 : 3mm (ON)

7

Switch

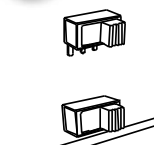

◇ SW8: ON/OFF

8

Push-buttons

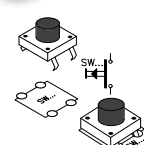

◇ SW1 ... SW7

9

Transistor

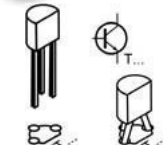

◇ T1: BC547B

10

Voltage regulator

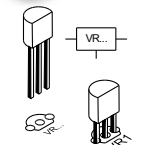

◇ VR1: KY5033-33LPE3

12

Electrolytic capacitors

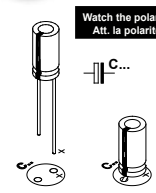

◇ C7 ... C9: 100µF

13

IC

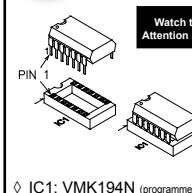

◇ IC1: VMK194N (programmed PIC16F1503-IP)
◇ IC2: LM386

14

Speaker

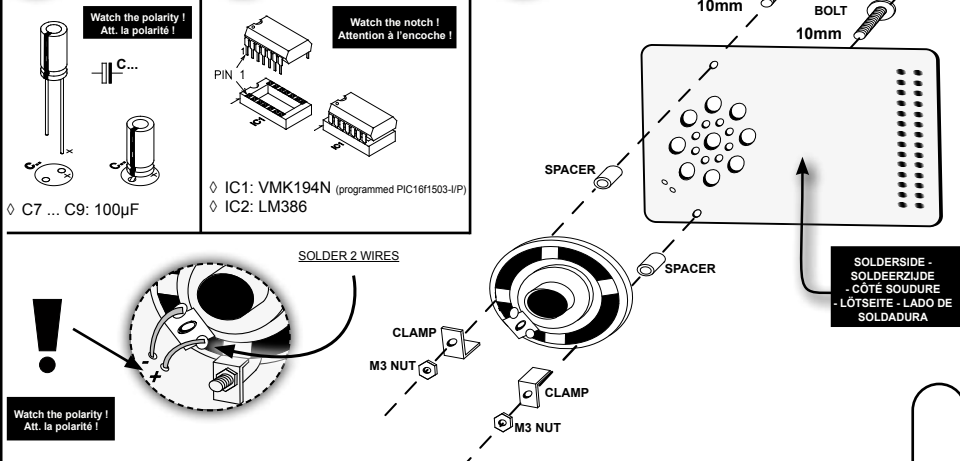

Watch the polarity !
Att. la polarité !

11

Battery holder + battery snap

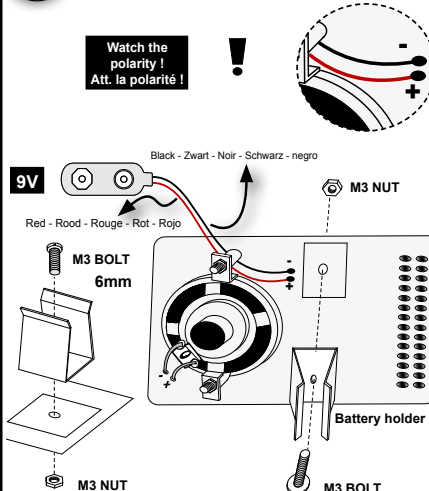

9V

Red - Rood - Rouge - Rot - Rojo

M3 NUT

15

FM receiver mini module + Antenna

◇ FM receiver mini module: MM100

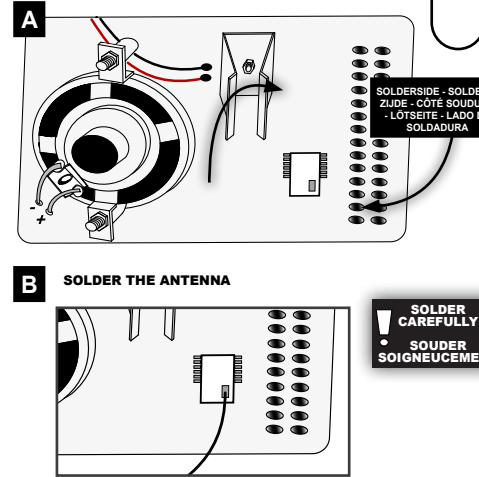

SOLDER CAREFULLY
SOUDEZ SOIGNEUSEMENT