

Soldering - Solderen - Soudage - Löten - Soldadura - Lötning - Juottaminen - Saldatura - Solda

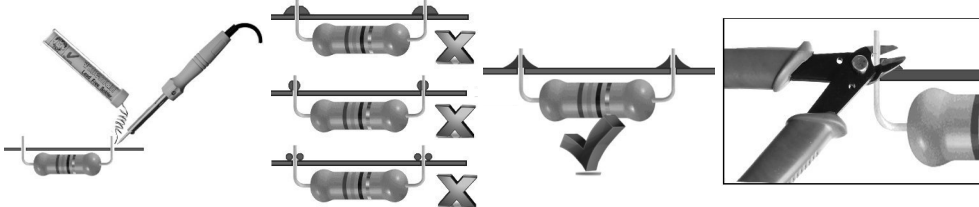

Component side - Componentenzijde - Côte composants - Bauteileseite - Lado de los componentes

START **1** Resistor - Weerstand - Résistance - Widerstand - Resistencia - Motstand - Vastus - Resistenze

◇ R1 : 33 ohm (Orange, Orange, Black) - (Oranje, Oranje, Zwart) - (Orange, Orange, Noir) - (Orange, Orange, Schwarz) - (Orange, Orange, Svart) - (Oranssi, Oranssi, Musta) - (Naranjado, Naranjado, Negro) - (Laranja, Laranja, Preto) - (Aranciato, Aranciato, Nero)

◇ R2 : 330 ohm (Orange, Orange, Brown) - (Oranje, Oranje, Bruin) - (Orange, Orange, Brun) - (Orange, Orange, Braun) - (Orange, Orange, Brun) - (Oranssi, Oranssi, Ruskea) - (Naranjado, Naranjado, Marrón) - (Laranja, Laranja, Castanho) - (Aranciato, Aranciato, Marrone)

10 Terminal blocks

◇ SK1 : 2p (power)
◇ SK2 : 3p (output)

11 Electrolytic capacitors

Watch the polarity!
Att. la polarité!

◇ C1 : 220µF

12 Power relay

◇ RY1 : VR17V121C

13 Transistor

◇ T1 : BD139

14 Voltage regulator

◇ VR1 : UA7805

15 IC

Watch the notch!
Attention à l'encoche!

◇ IC1 : PIC16F676

16

IMPORTANT:
PUT AN EXTRA LAYER OF SOLDER ON ALL PRE-THINNED PCB TRACKS, TO IMPROVE THEIR CURRENT HANDLING CAPABILITIES.

2 Jumper

◇ J1

3 Diode

Watch the polarity!
Att. la polarité!

◇ D1, D2 : 1N4007

4 IC-Socket

Watch the notch!
Attention à l'encoche!

◇ IC1 : 14p

5 Resistor Array

◇ RA1 : 47K

6 Horizontal Trimmer

◇ RV1, RV2 : 4K7

7 Ceramic capacitors

◇ C2 ... C7 : 100nF (104)

8 Pin header

◇ 4 x 3p
◇ 2 x 2p

9 LED

Watch the polarity!
Att. la polarité!

◇ LD1 : red

