

1

Resistor - Weerstand - Résistance - Widerstand - Resistencia - Motstand - Vastus - Resistenze

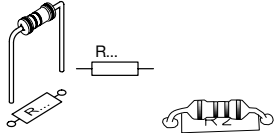

R1, R2 : 10K

R3...R6 : 220K

R7,R8 : 8E2

R9...R13 : 1K

R14,R15 : 47K

R16 : 0

(Brown, Black, Orange) -(Bruin, Zwart, Oranje) -(Brun, noir, Orange) -(Braun, Schwarz, Orange) -(Brun, Svart, Orange) -(Ruskea, Musta, Oranssi) -(Marrón, Negro, Naranja) -(Castanho, Preto, Laranja) -(Marrone, Nero, Aranciato)

(Red, Red, Yellow) -(Rood, Rood, Geel) -(Rouge, Rouge, Jaune) -(Rot, Rot, Gelb) -(Röd, Röd, Gul) -(Punainen, Punainen, Keltainen) -(Rojo, Rojo, Amarillo) -(Encarnado, Encarnado, Amarelo) -(Rosso, Rosso, Giallo)

(Grey, Red, Gold) -(Grijs, Rood, Or) -(Gris, Rouge, Gold) -(Grau, Rot, Gold) -(Grà, Röd, Kulita) -(Harmaa, Punainen, Oro) -(Gris, Rojo, Dourado) -(Cinzent, Encarnado, Oro) -(Grigio, Rosso, Guld)

(Brown, Black, Red) -(Bruin, Zwart, Rood) -(Brun, Noir, Rouge) -(Braun, Schwarz, Rot) -(Brun, Svart, Röd) -(Ruskea, Musta, Punainen) -(Marrón, Negro, Rojo) -(Castanho, Preto, Encarnado) -(Marrone, Nero, Rosso)

(Yellow, Purple, Orange) -(Geel, Paars, Oranje) -(Jaune, Violet, Orange) -(Gelb, Violet, Orange) -(Gul, Lila, Orange) -(Keltainen, Purppura, Oranssi) -(Amarillo, Morado, Naranja) -(Amarelo, Violeta, Laranja) -(Giallo, Viola, Aranciato)

(Black) -(zwart) -(noir) -(Schwarz) -(Svart) -(Musta) -(Negro) -(Preto) -(Nero)

2

CAPACITOR

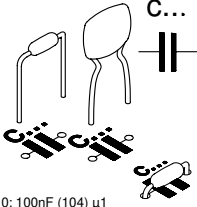

◇ C10: 100nF (104) μ F
◇ C11,C12: 100pF (100, 101)

3

LEDs

Watch the polarity !
Attention à la polarité !

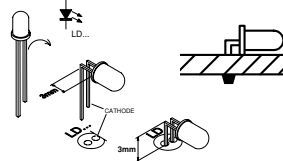

◇ LD1 : red / rood / rouge / rot / röd / punainen / rojo / encarnado / rosso

4

SWITCH

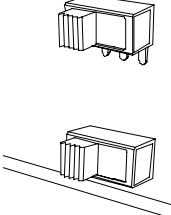

◇ SW1

5

IC SOCKET

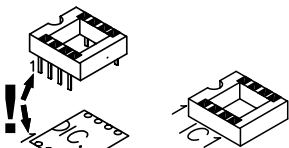

Watch the polarity !
Attention à la polarité !

◇ IC1 : 8P

6

PCB TABS

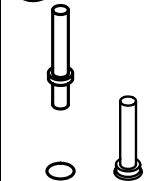

◇ MicL
◇ MicR

7

MICROPHONES

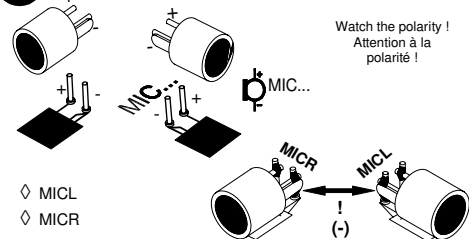

Watch the polarity !
Attention à la polarité !

◇ MICL
◇ MICR

8

ELECTROLYTIC CAPACITORS

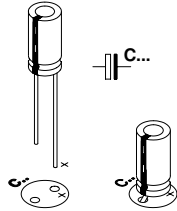

Watch the polarity !
Attention à la polarité !

◇ C1...C4 : 1 μ F
◇ C5...C7 : 470 μ F
◇ C8,C9 : 10 μ F

9

PHONEJACK

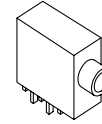

◇ SK2

10

POTENTIOMETER

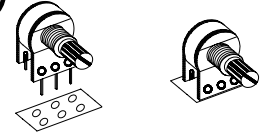

potentiometer - Potentiomètre -
Potentiometro - potentiometri -
potenziometro - potenziometri

◇ RV1 : 50K

11

IC

WATCH THE POSITION
OF THE NOTCH !

ATTENTION A LA POSITION
DE L'ENCOCHE !

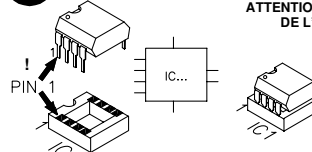

◇ IC1 : NE5532 or eq.

12

BATTERY HOLDER & FINAL ASSEMBLY

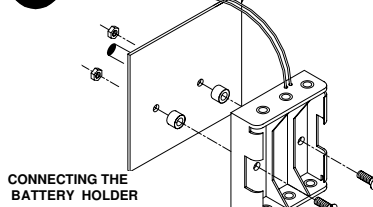

CONNECTING THE
BATTERY HOLDER

RED (+)
BLACK (-)
PLACE 3 'AA' BATTERIES
HERE !
Watch the polarity !
Attention à la polarité !

