

START

1

**Resistor - Weerstand - Résistance - Widerstand - Resistencia - Motstand - Vastus - Resistenze**

◇ R1,R2: (Yellow, Purple, Orange) -(Gelb, Paars, Orange) -(Jaune, Violet, Orange) -(Gelb, Violet, Orange) -(Gel, Lila, Orange) -(Keltainen, Purppura, Oranssi) - (Amarillo, Morado, Naranja) -(Amarelo, Violeta, Laranja) - (Giallo, Viola, Aranciato)

◇ R3, ..., R14 : (Red, Red, Brown) -(Rood, Rood, Bruin) -(Rouge, Rouge, Brun) -(Rot, Rot, Braun) -(Röd, Röd, Brun) -(Punainen, Punainen, Ruskea) -(Rojo, Rojo, Marrón) -(Encarnado, Encarnado, Castanho) -(Rosso, Rosso, Marrone)

◇ R15 : 0 (Black) -(zwart) -(noir) -(Schwarz) -(Svart) -(Musta) -(Negro) -(Preto) -(Nero)

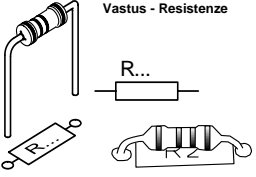

2

**CAPACITOR**

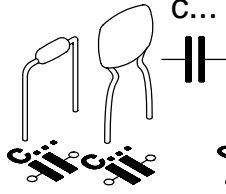

◇ C1 : 100nF (104) µ1

3

**LEDs**

0 : Yellow/Gelb/Jaune/Gelb/Gul/Keltainen/Amarillo/Amarelo/Giallo

32,19,21,25,34,27,36,30,23,5,16,1,14,9,18,7,12,3 : Red/Rood/Rouge/Rot/Röd/Punainen/Rojo/Encarnado/Rosso

15,4,2,17,6,13,11,8,10,24,33,20,31,22,29,28,35,26 : Green/Groen/Vert/Grün/Grön/Vihreä/Verde

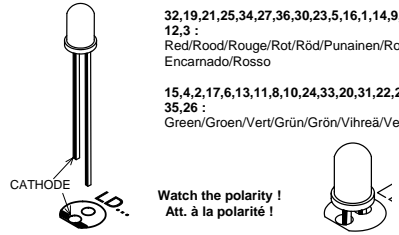

Watch the polarity !  
Att. à la polarité !

8

**BATTERY HOLDER**

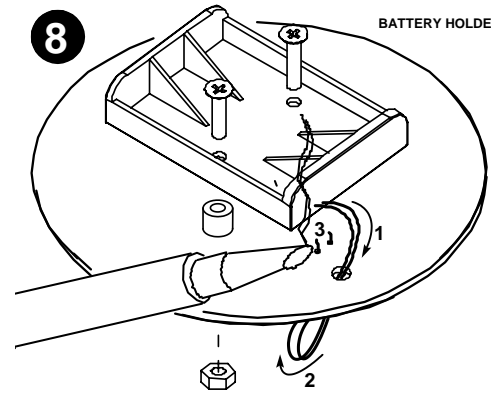

9

**IC**

Watch the position of the notch !  
Attention à la position de l'encoche !

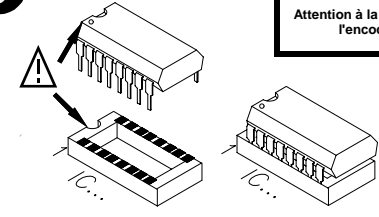

◇ IC1 : VMK119 (prog. PIC16C505)  
◇ IC2 : 4N33 or eq.

4

**PUSHBUTTON**

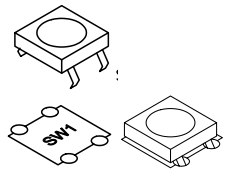

◇ SW1

5

**IC SOCKET**

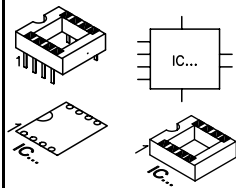

◇ IC1 : 14P  
◇ IC2 : 6P

6

**TRANSISTOR**

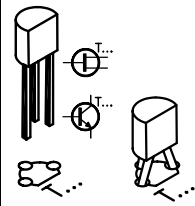

◇ T1 : BC557

7

**BUZZER**

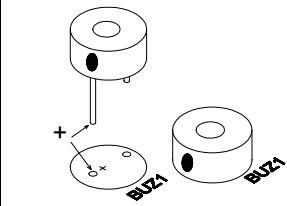

◇ BUZ1

