



**A** Parts mounted at solder side! - Onderdelen langs de soldeerzijde! - Eléments du côté soudure! - Elemente entlang der Lötseite! - Elementos del lado soldadura! - Delar monterade på kretskortets lödsida - Parti dal lato dove bisogna saldare! - Komponenter, monteret på loddessiden! - Osat asennetaan juotospuolelle! - Partes montadas no lado da soldadura.

**1**

Resistor -  
Weerstand -  
Résistance -  
Widerstand -  
Resistencia -  
Motstand -  
Vastus -  
Resistenze

- ◇ R1... R6: 470 (Yellow, Purple, Brown) - (Geel, Paars, Bruin) - (Jaune, Violet, Brun) - (Gelb, Violet, Braun) - (Gul, Lila, Bruin) - (Keltainen, Purppura, Ruskea) - (Amarillo, Morado, Marrón) - (Amarelo, Violeta, Castanho) - (Giallo, Viola, Marrone)
- ◇ R7... R32: 1K (Brown, Black, Red) - (Bruin, Zwart, Rood) - (Brun, Noir, Rouge) - (Braun, Schwarz, Rot) - (Brun, Svart, Röd) - (Ruskea, Musta, Punainen) - (Marrón, Negro, Rojo) - (Castanho, Preto, Encarnado) - (Marrone, Nero, Rosso)
- ◇ R33... R36: 3K3 (Orange, Orange, Red) - (Oranje, Oranje, Rood) - (Orange, Orange, Rouge) - (Orange, Orange, Rot) - (Orange, Orange, Röd) - (Oranssi, Oranssi, Punainen) - (Naranjado, Naranjado, Rojo) - (Laranja, Laranja, Encarnado) - (Aranciato, Aranciato, Rosso)
- ◇ R37... R41: 47K (Yellow, Purple, Orange) - (Geel, Paars, Oranje) - (Jaune, Violet, Orange) - (Gelb, Violet, Orange) - (Gul, Lila, Orange) - (Keltainen, Purppura, Oranssi) - (Amarillo, Morado, Naranjado) - (Amarelo, Violeta, Laranja) - (Giallo, Viola, Aranciato)

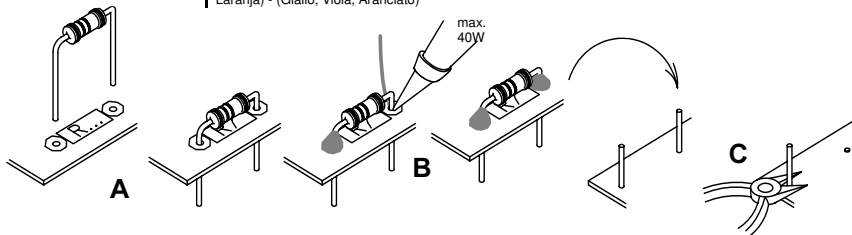
**2**

Transistor

- ◇ T1... T6: BC557
- ◇ T7, T8: BC547

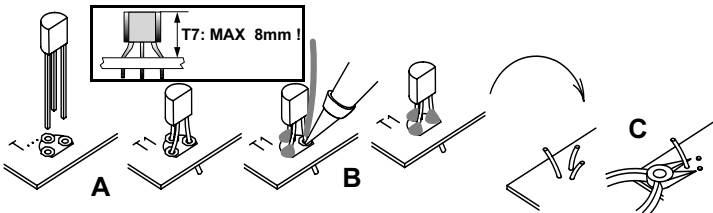
**3**

- ELCO ◇ C1, C2, C3: 2μ2 Watch the polarity! - Att. la polarità!  
◇ C4, C5: 10μF

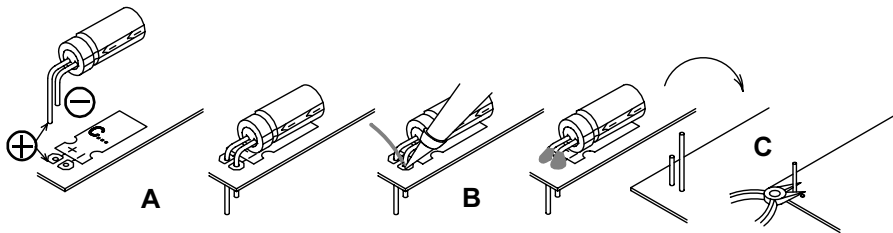

**B** Parts mounted at component side! - Onderdelen langs de componenten zijde! - Eléments du côté composants! - Elemente entlang der Bauteilseite! - Elementos del lado componentes! - Delar monterade på kretskortets komponentsida! - Parti dal lato dove si trovano i componenti! - Komponenter, monteret på komponentsiden! - Osat asennetaan komponenttipuolelle! - Partes montadas no lado dos componentes.

**4**

LED 3mm

- ◇ 28 X = Green, Groen, Vert, Grün, Grön, Vihreä, Verde
- ◇ 51X = Yellow, Geel, Jaune, Gelb, Gul, Keltainen, Amarillo, Amarelo, Giallo.
- ◇ 47X = Red, Rood, Rouge, Rot, Röd, Punainen, Rojo, Encarnado, Rosso.

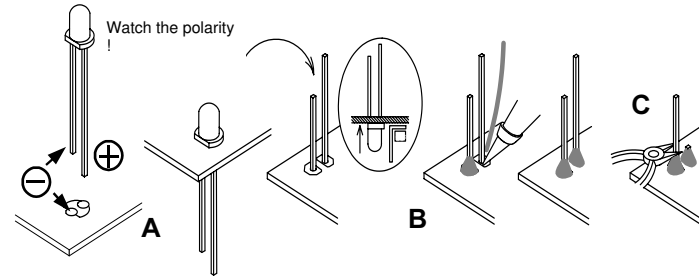
**5**

◇ DC Jack

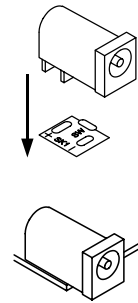
**6**

◇ SW1

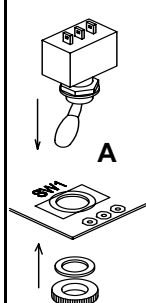

- Mount the switch and make the connections.
- Monteer de schakelaar en maak de verbindingen.
- Montez l'interrupteur et faites la connexion.
- Montieren Sie den Schalter und legen Sie die Verbindung.
- Montera strömbrytaren, och löd anslutningarna.
- Montar el interruptor y hacer la conexión
- Montare l'interruttore e collegare.
- Monter kontakten, og træk ledningerne
- Asenna kytkin ja tee kytkentä.
- Montar o interruptor e fazer as restantes ligações

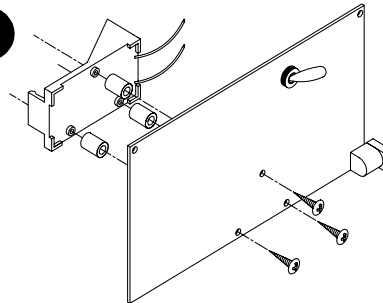
**7**

Red, Rood, Rouge, Rot, Röd, Punainen, Rojo, Encarnado, Rosso.

