

### 3 CONFIGURE THE MODULES *(continuation)*

9. Press the  “Synchronize” button. In the “Synchronize Project” dialog, make sure “Only write changes” is checked, and press “Write”

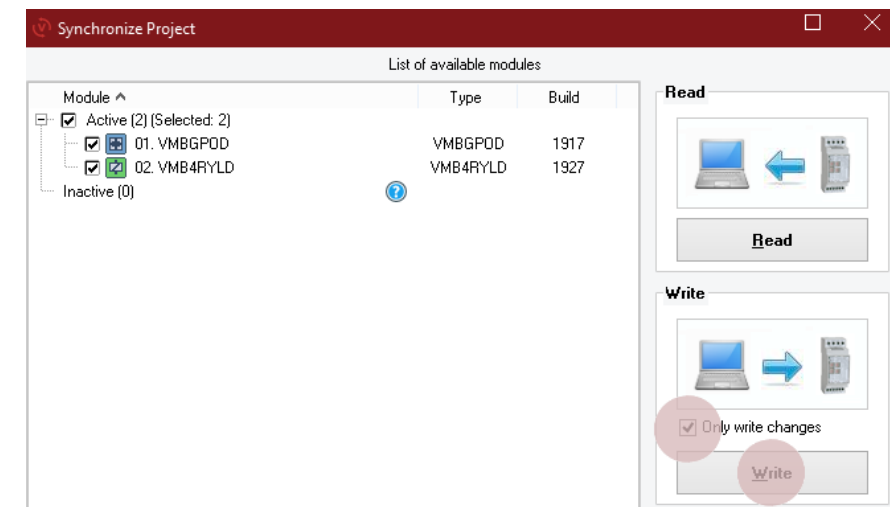

When the writing has finished (this should take only a few seconds), you can now operate Relay 1 (“Light kitchen”) by pressing the upper left touch button (Channel 1) of the glass control module.

### 4 EXTRA

To change the text on the OLED screen, select the VMBGPOD module in VelbusLink and click on the gear icon.

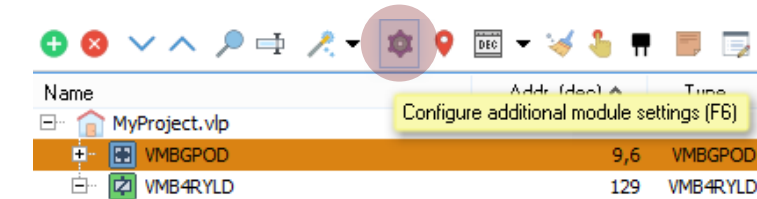

In the Configuration window, click on the “edit bitmap” button and add names and icons:

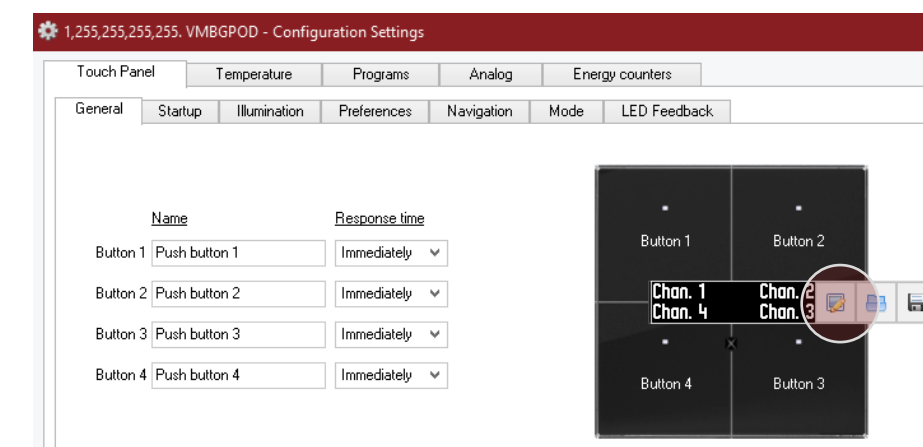

In the Configuration window, you can find a lot of other settings concerning feedback lights, navigation, screensaver settings etc. Don't forget to sync (write the changes to the modules) before testing the changes you made.

### 5 TROUBLESHOOTING

If something doesn't work out as expected, first carefully check the wiring, make sure the terminators are set as described above, and power cycle the installation. If this doesn't solve your problem, please refer to the support pages on [www.velbus.eu](http://www.velbus.eu), or contact your dealer.

### 6 MORE INFORMATION

The Velbus Installation Guide is a complete, detailed manual on Velbus hardware (Part 1) and configuration (Part 2). Download it for free on [www.velbus.eu](http://www.velbus.eu). On our website you will also find our product catalogue, product specifications, an FAQ section, downloads, points of sale, and much more.

#### WARNING

- Velbus products must be installed by a professional installer.
- All installation, maintenance and repair activities must be performed on an isolated and voltage-free installation.
- Install according to the applicable regulations of the country.
- Respect good engineering practice.

If in doubt, contact your wholesaler. Contact: [info@velbus.eu](mailto:info@velbus.eu)



[www.velbus.eu](http://www.velbus.eu)

Velleman • Legen Heirweg 33 • 9890 Gavere • België

GETTING STARTED WITH VELBUS

## 1 INSTALL THE HARDWARE

Connect all the modules using the included VMBRAIL-R interconnection rail and a 4-wired bus cable (not included, we recommend EIB or FTP).

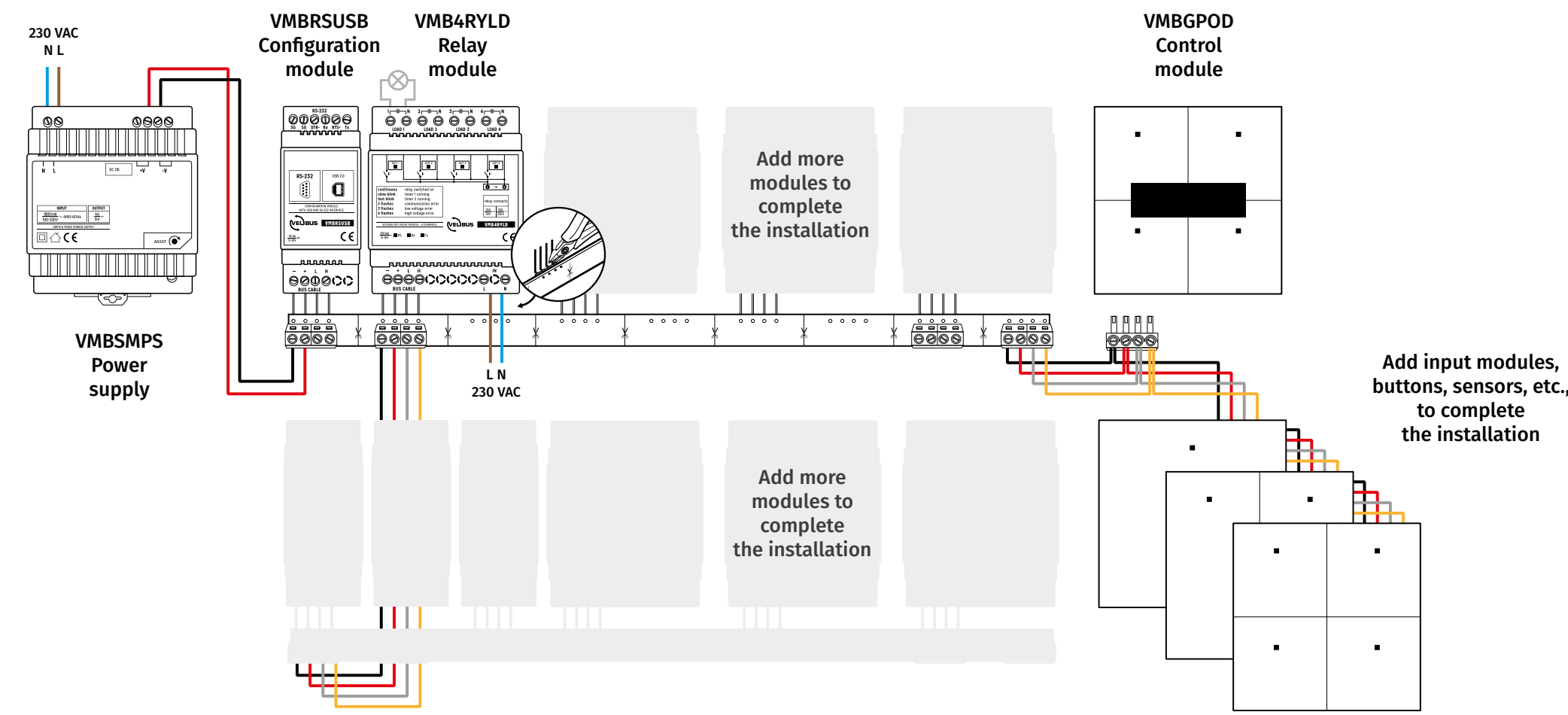

## 2 SET THE TERMINATORS

Most Velbus modules have a terminator (jumper or switch) that by factory default is open. **In a standard Velbus installation exactly two of these terminators have to be closed**, with as much distance (wire) between them as possible.

For DIN-rail modules open the front cover plate (see image below) to find the terminator. For other modules, you will find it at the back of the module. If the terminator is a jumper, place it over the two “TERM” pins (see image below) to close it. If it is a switch, set it to the “ON” position.

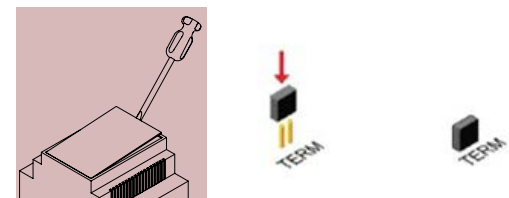

## 3 CONFIGURE THE MODULES

You can find complete instructions on how to configure Velbus modules in the Velbus Installation Guide Part 2: Configuration (free download on [www.velbus.eu](http://www.velbus.eu)).

To get you started, here’s how to configure an on/off switch:

1. Connect your PC with the Velbus configuration module using the included USB cable.
2. Download, install and start VelbusLink, the free configuration software for Velbus. ([www.velbus.eu/velbuslink](http://www.velbus.eu/velbuslink)).
3.  Click on “New” (upper left corner) to start the “New project wizard”.
4. Follow the wizard by clicking on “Next” until you get the message “Your project has been created successfully”.



5.  In the navigation window, fold open the VMBGPOD and the VMB4RYNO modules by clicking on the “+” signs next to their names.

6. (Optional) Left-click on the name of a selected module or channel to change it. Eg. change “Relay 1” to “Light kitchen”



7. Drag “Button 1” and drop it on relay 1 (“Light kitchen”)

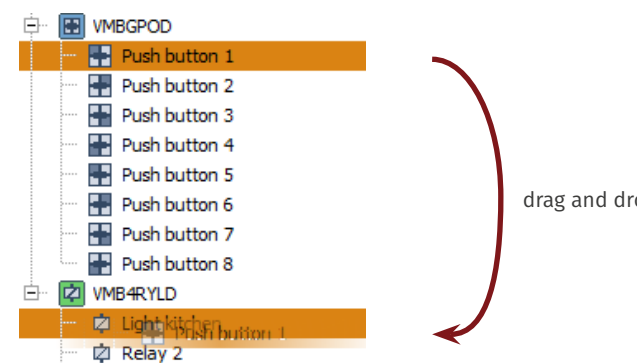

8. In the dialog that opens, select “Toggle” and press “OK”

