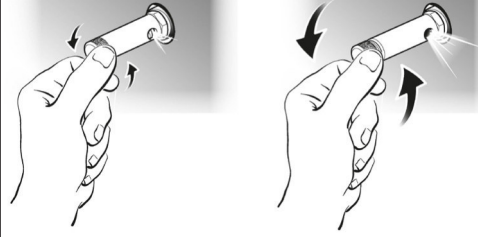

**1****GB**

The safety valve has been set for the highest permitted pressure of the pressure vessel. It is prohibited to adjust the safety valve.

Actuate the safety valve from time to time to ensure that it works when required. Turn the nut until you can hear the compressed air being released (Fig. 1). Then screw it back on.

Always keep the safety valve and the surrounding area clean and free of obstructions.